

## Capacidade de Carga - Load Capacity - Capacidad de carga

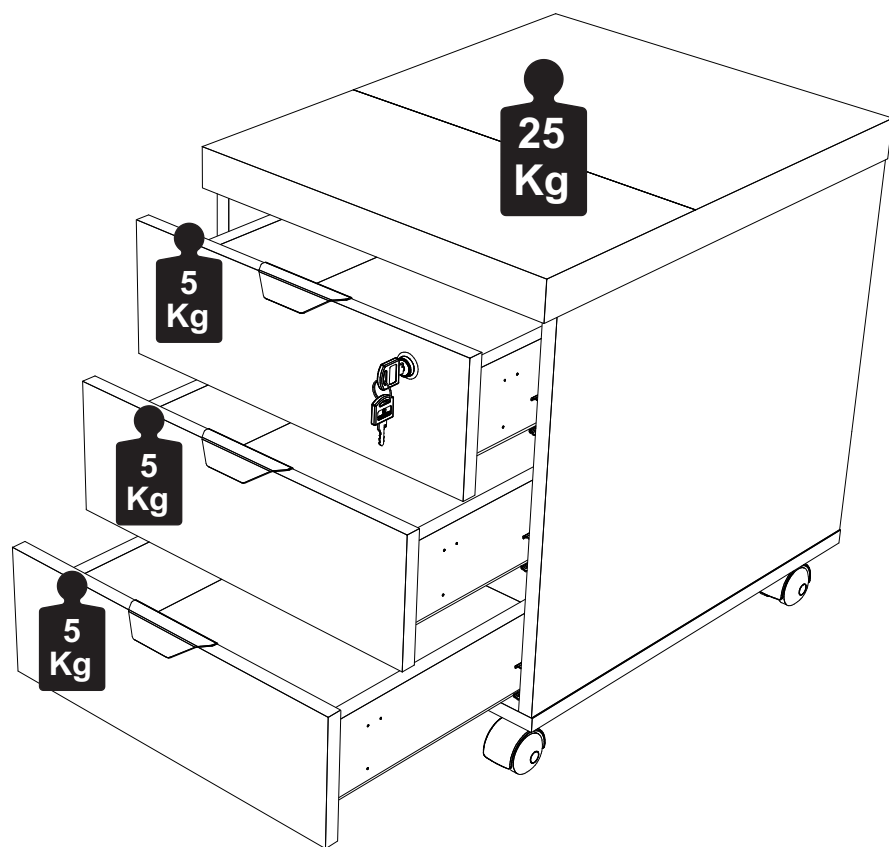

### Manutenção e Limpeza

Vidros: pano levemente umedecido com álcool, seguido de pano seco.  
Madeiras: pano levemente umedecido com água, seguido de pano seco.  
\*Nunca utilizar produtos químicos ou abrasivos.

### Maintenance and Cleaning

Glasses: cloth lightly moistened with alcohol, followed by dry cloth.  
Woods: cloth slightly moistened with water, followed by cloth seo.  
\*Never use chemicals or abrasives.

### Mantenimiento y Limpieza

Vidrios: legeramente humedecido con alcohol, seguido de un paño seco.  
Madera: ligeramente humedecido con agua, seguido de un paño seco.  
\*No utilice nunca productos quimicos o abrasivos.

## INSTRUÇÕES DE MONTAGEM ASSEMBLY INSTRUCTIONS INSTRUCCIONES DE MONTAJE

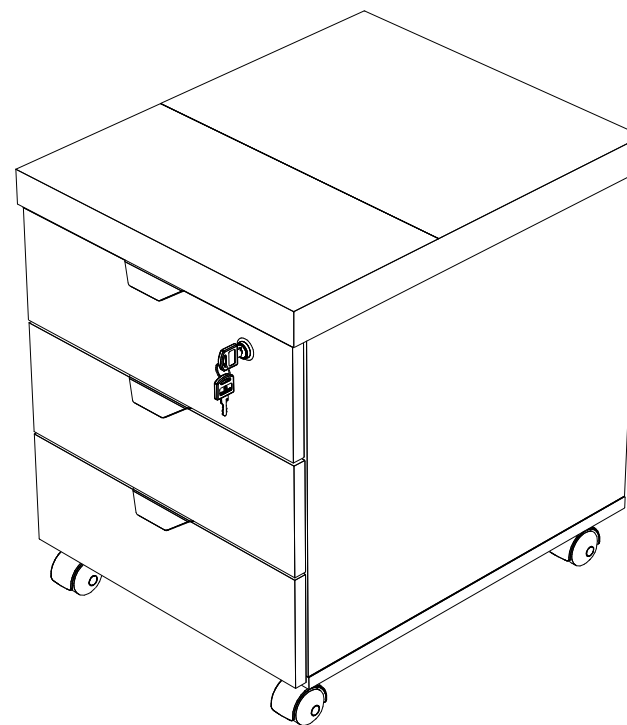

São necessários:  
Son necesarios:  
Are necessary:



\*Parafusadeira  
Atornillador  
Screwdriver



\*Martelo  
Martillo  
Hammer



Chave Cruzada  
Llave cruzada  
Cross wrench

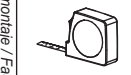

\*\*Trena  
Cinta métrica  
Measuring tape



90min



1 Pessoas  
Persona  
Person

\*Facilita a montagem / Facilita un montaje / Facilitates mounting.  
\*\* Para identificar as peças / Para identificar las partes / To identify the parts.

REF. # BOS4051

 **Gebbwork**

MOBILIÁRIO  
PARA ESCRITÓRIO

GEBB Work Ind. de Móveis Ltda.  
Rua Felix Roman, 190  
São Valentin

95709-170 - Bento Gonçalves - RS - Brasil  
Fone: (0XX54) 3454-1105 - (0XX54) 3453-1407  
Phone: (0XX54) 3454-1105 - (0XX54) 3453-1407  
E-mail: pedidos@gebbwork.com.br  
www.gebbwork.com.br

REV.: 00 - 19/04/2025

WhatsApp: +55 54 99177-8324

01/05

# LISTA DE PEÇAS

Parts Identification

Lista de Piezas

**3X**

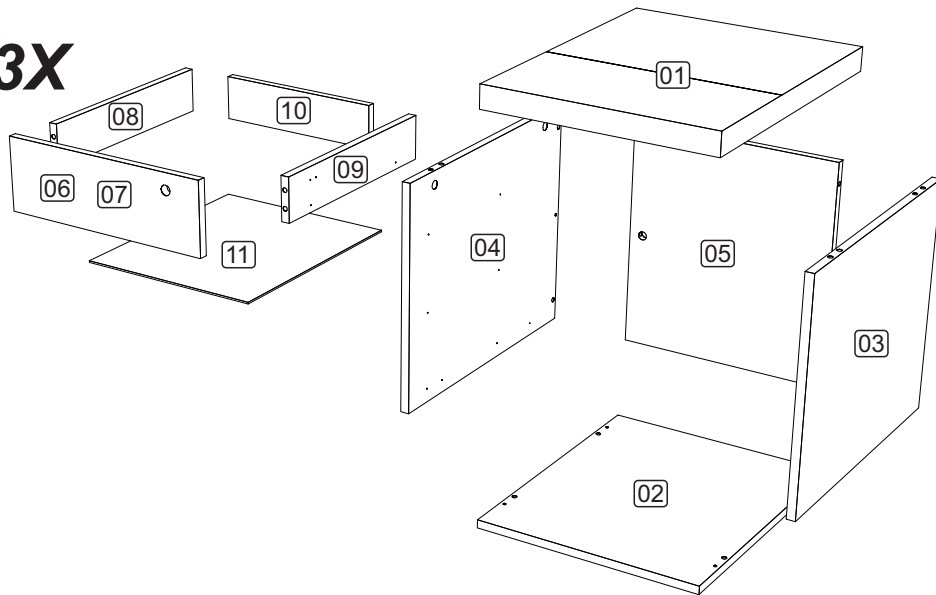

## LISTA DE PEÇAS

- 01 - TAMPO
- 02 - BASE
- 03 - LATERAL DIREITA
- 04 - LATERAL ESQUERDA
- 05 - COSTA
- 06 - FRENTE GAVETA
- 07 - FRENTE GAVETA C/ FECH
- 08 - LATERAL GAVETA ESQ.
- 09 - LATERAL GAVETA DIR.
- 10 - COSTA DE GAVETA
- 11 - FUNDO DE GAVETA

## LISTA DE PIEZAS

- 01 - TABLERO DE MESA
- 02 - BASE
- 03 - LADO DERECHO
- 04 - LATERAL IZQUIERDO
- 05 - COSTA
- 06 - FRENTE DE CAJÓN
- 07 - FRENTE DE CAJÓN CON CERRADURA
- 08 - LADO CAJÓN IZQUIERDO.
- 09 - LADO CAJÓN DERECHO.
- 10 - TRASERO DEL CAJÓN
- 11 - FONDO DEL CAJÓN

## PARTS IDENTIFICATION

- 01 - TOP
- 02 - BASE
- 03 - RIGHT SIDE
- 04 - LEFT SIDE
- 05 - BACK
- 06 - DRAWER FRONT
- 07 - DRAWER FRONT W/LOCK
- 08 - LEFT DRAWER SIDE
- 09 - RIGHT DRAWER SIDE
- 10 - DRAWER BACK
- 11 - DRAWER BOTTOM

# Acessórios

Accessories

Accesorios

A8 - PARAF. 4,0x14 CP  
**22x**



A35 - TAMBOR MINIFIX  
**12x**



A32 - PARAF. MINIFIX  
**12x**

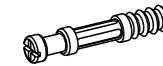

D1 - CAVILHA 8x30  
**18x**

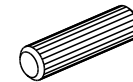

A2 - PARAF. 3,5x14 CC  
**28x**



A3 - PARAF. 3,5x20 CP  
**27x**



J3 - TRILHO TELESCÓPICO  
350MM **3x**

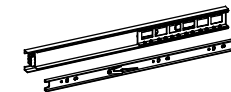

C11 - PUXARDOR  
MET. BOSS  
**3x**

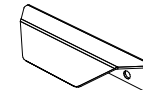

I1 - FECHADURA P/GAV.  
**1x**



M1 - CHAPA L 2 FUROS  
OBL 42x17x0,9mm ZB



**1x**

A6 - PARAF. 3,5x40 CC  
**4x**



H6 - CANTONEIRA P/GAV  
QUICK INSTALL **6x**



B25 - SEPARADOR PARA  
FECHADURA **1x**



C2 - RODÍZIOS  
**4x**





2

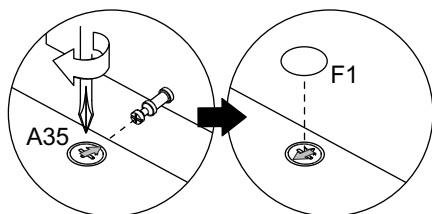
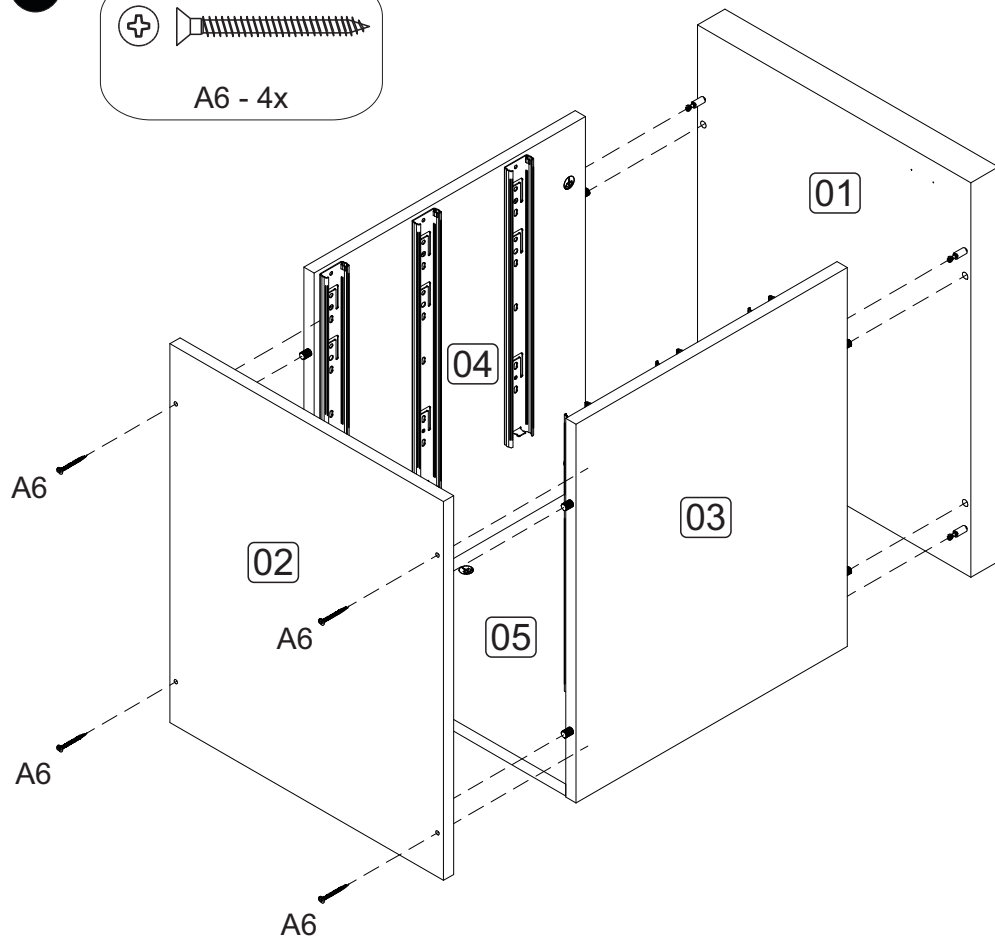
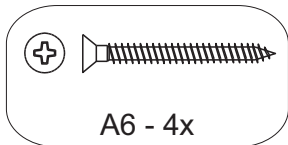

Depois de encaixar as peças coloque o tambor com a sua seta voltada para o parafuso. Para apertar Gire no sentido horário.  
 Después de colocar las piezas, coloque el tambor con su flecha hacia el tornillo. Para apretar, gire en sentido horario.  
 After fitting the parts, place the drum with its arrow facing the screw.  
 To tighten, turn clockwise.

3

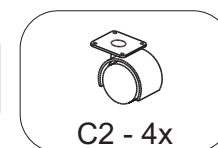
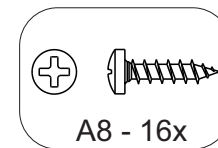
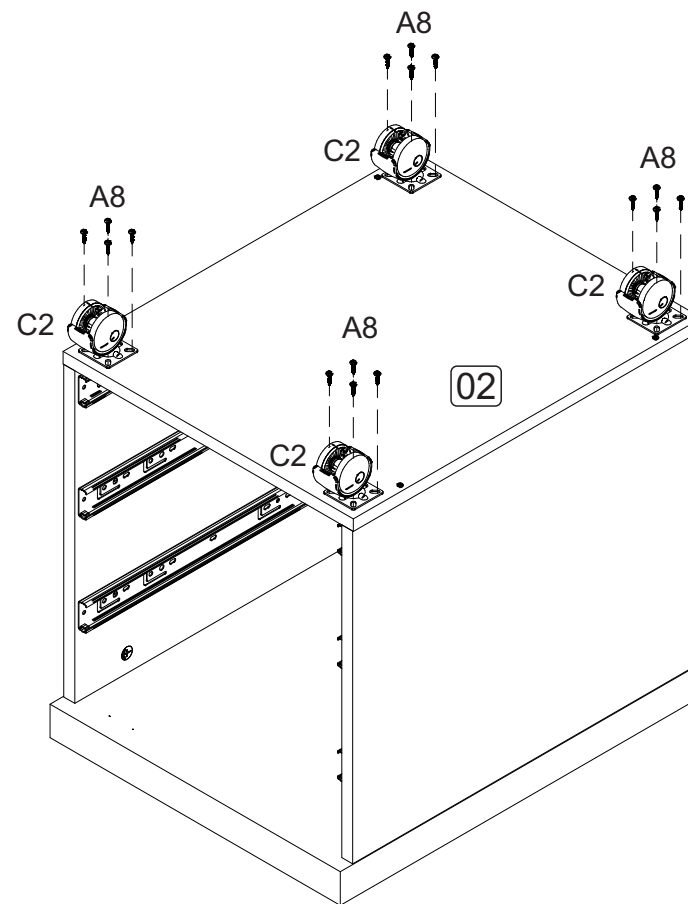

4

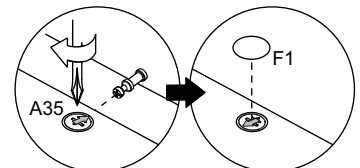
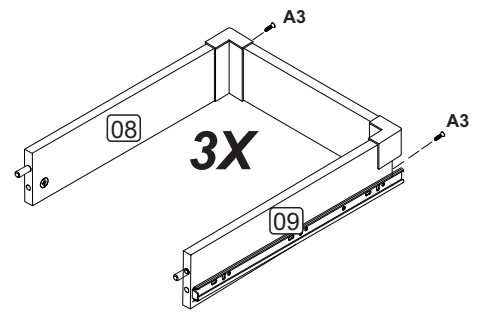
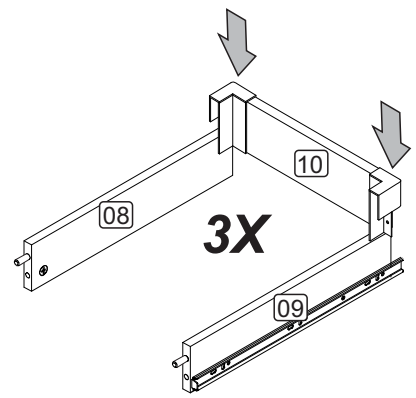
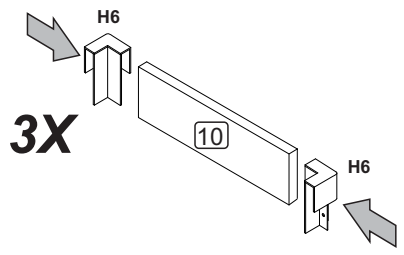

Depois de encaixar as peças coloque o tambor com a sua seta voltada para o parafuso. Para apertar Gire no sentido horário.  
 Después de colocar las piezas, coloque el tambor con su flecha hacia el tornillo. Para apretar, gire en sentido horario.  
 After fitting the parts, place the drum with its arrow facing the screw. To tighten, turn clockwise.

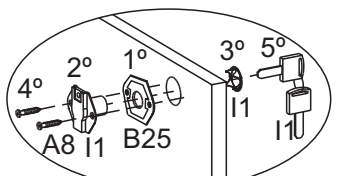
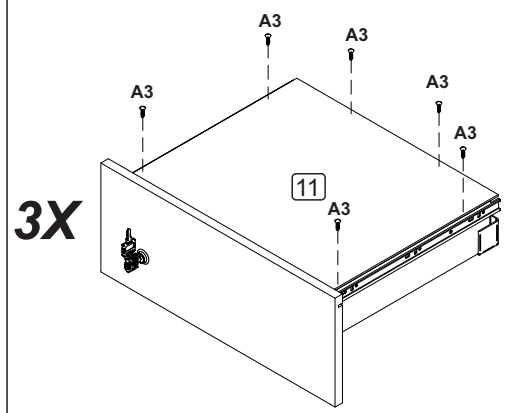
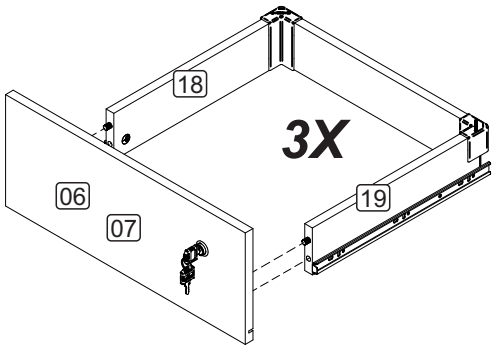

Siga a ordem crescente de instalação.  
 Siga el orden ascendente de instalación  
 Follow the ascending order of installation

- |          |         |          |
|----------|---------|----------|
| B25 - 1x | I1 - 1x | A8 - 6x  |
| F1 - 6x  | H6 - 6x | A3 - 24x |

5

