

Capacidade de Carga - Load Capacity - Capacidad de carga

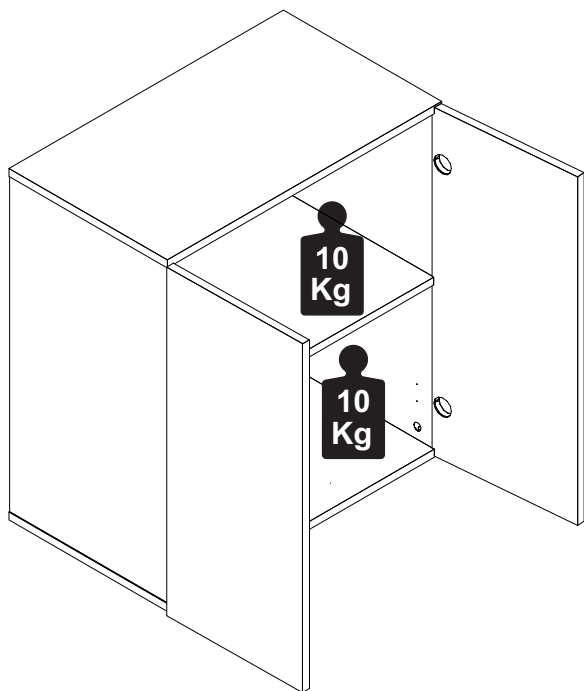

Manutenção e Limpeza

Vidros: pano levemente umedecido com álcool, seguido de pano seco.
Madeiras: pano levemente umedecido com água, seguido de pano seco.
*Nunca utilizar produtos químicos ou abrasivos.

Maintenance and Cleaning

Glasses: cloth lightly moistened with alcohol, followed by dry cloth.
Woods: cloth slightly moistened with water, followed by cloth seo.
*Never use chemicals or abrasives.

Mantenimiento y Limpieza

Vidrios: legeramente humedecido con alcohol, seguido de un paño seco.
Madera: ligeramente humedecido con agua, seguido de un paño seco.
*No utilice nunca productos quimicos o abrasivos.

INSTRUÇÕES DE MONTAGEM ASSEMBLY INSTRUCTIONS INSTRUCCIONES DE MONTAJE

ARMÁRIO CUPBOARD ARMARIO

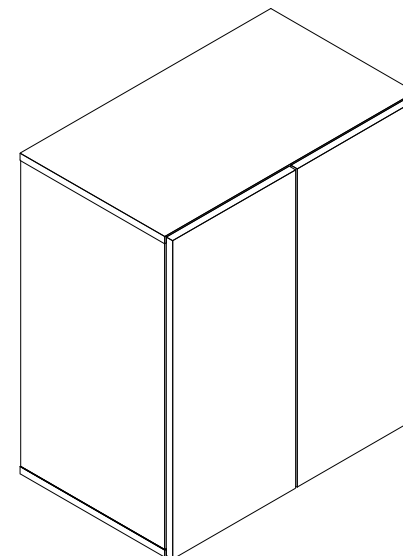

1 P.



15mim

REF. #SLF6070-6311-6314-6318-6371



MOBILIÁRIO
PARA ESCRITÓRIO

GEBB Work Ind. de Móveis Ltda.
Rua Felix Roman, 190
São Valentin

95709-170 - Bento Gonçalves - RS - Brasil
Fone: (0XX54) 3454-1105 - (0XX54) 3453-1407
Phone: (0XX54) 3454-1105 - (0XX54) 3453-1407
E-mail: pedidos@gebbwork.com.br

www.gebbwork.com.br
WhatsApp: +55 54 99177-8324

LISTA DE PEÇAS

LISTA DE PEÇAS

- 01 - Lateral Esquerda / Direita
- 02 - Tampo / Base
- 03 - Prateleira
- 04 - Porta Esquerda / Direita
- 05 - Costa

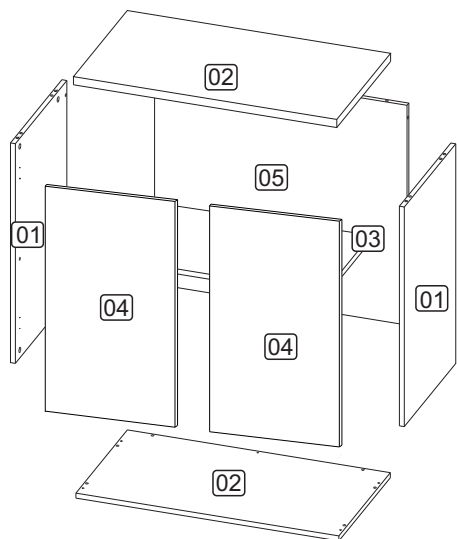

LISTA DE PIEZAS

- 01 - Lateral Izquierda / Derecha
- 02 - Tapa / Base
- 03 - Plataforma
- 04 - Puerta Izquierda / Derecha
- 05 - Revés

PARTS IDENTIFICATION

- 01 - Left Side / Right Side
- 02 - Top / Base
- 03 - Shelf
- 04 - Left / Right Door
- 05 - Back

5

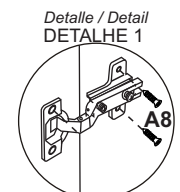
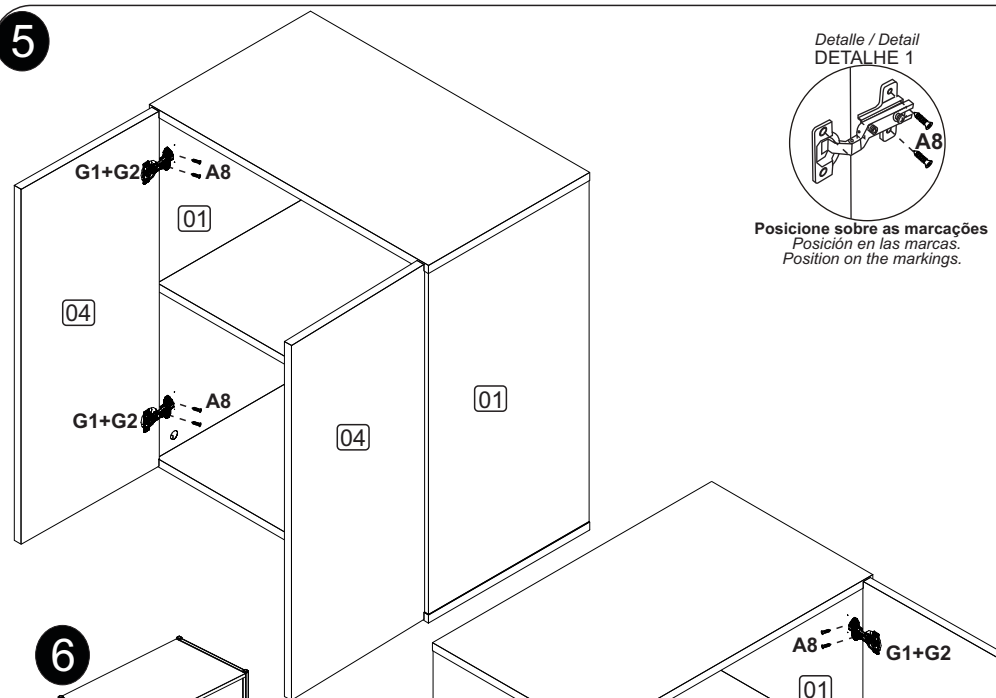

Posicione sobre as marcações.
Posición en las marcas.
Position on the markings.

6

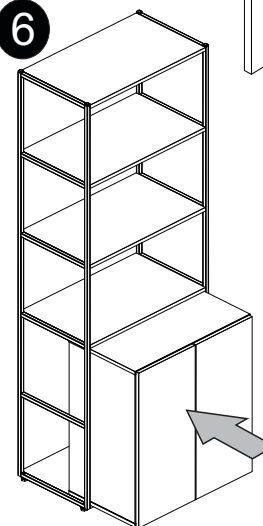

Fixar armário na estrutura através do parafuso A4.

PARA INSTALAR O FECHO TOQUE (PULSADOR MAGNÉTICO) LEIA O MANUAL CONTIDO NELE



H15 - 2X

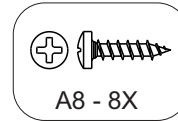

A8 - 8X

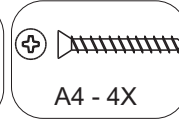

A4 - 4X

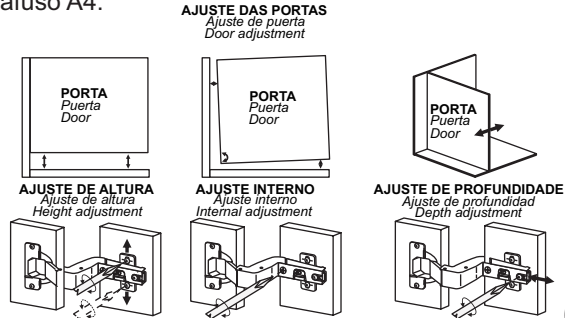

AJUSTE DAS PORTAS
Ajuste de puerta
Door adjustment

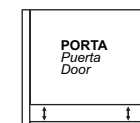

PORTA
Puerta
Door

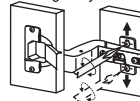

AJUSTE DE ALTURA
Ajuste de altura
Height adjustment



PORTA
Puerta
Door

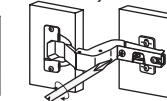

AJUSTE INTERNO
Ajuste interno
Internal adjustment



PORTA
Puerta
Door

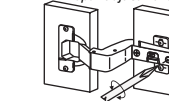

AJUSTE DE PROFUNDIDADE
Ajuste de profundidad
Depth adjustment

3

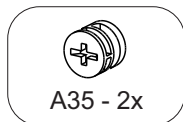
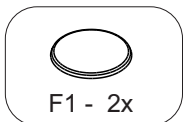
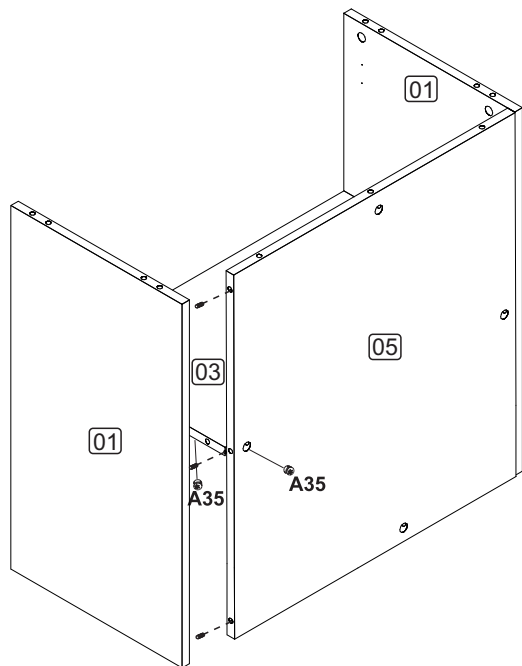

4

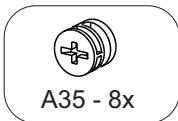
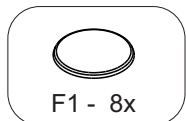
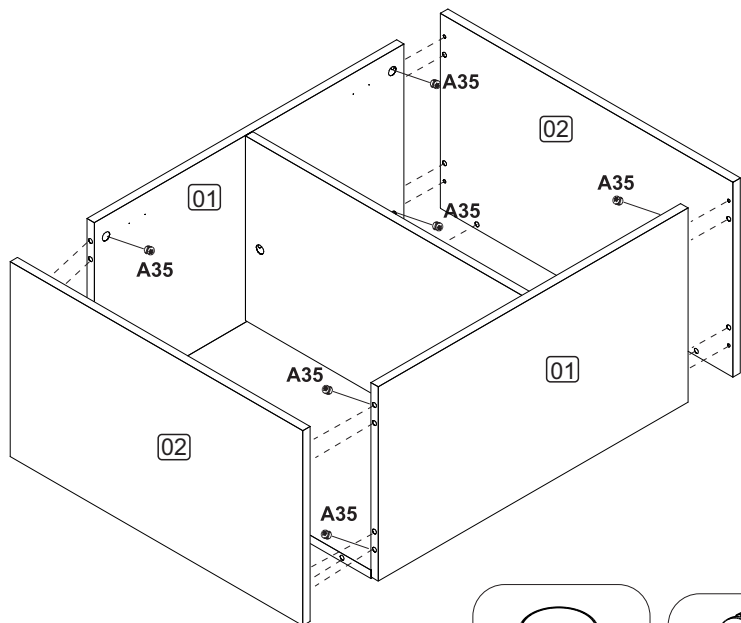

ACESSÓRIOS ACCESSORIES ACCESORIOS

A32 - PARAF. MINIFIX
14x

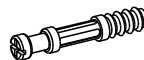

A35 - TAMBOR MINIFIX
14x



A8 - PARAF. 4,0x14 CP
16x



G1 - DOBRADIÇA
CANECO 35 BAIXO **4x**

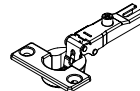

D1 - CAVILHA 8x30
20x

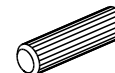

F1 - TAPA FURO ø18
14x



G2 - CALÇO ALTO P/
DOBRADIÇA **4x**



H15-PULSADOR MAGNETICO
2x



A4 - PARAF. 3,5x25 CC
4x



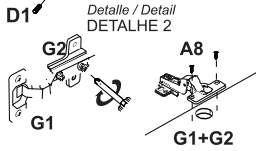
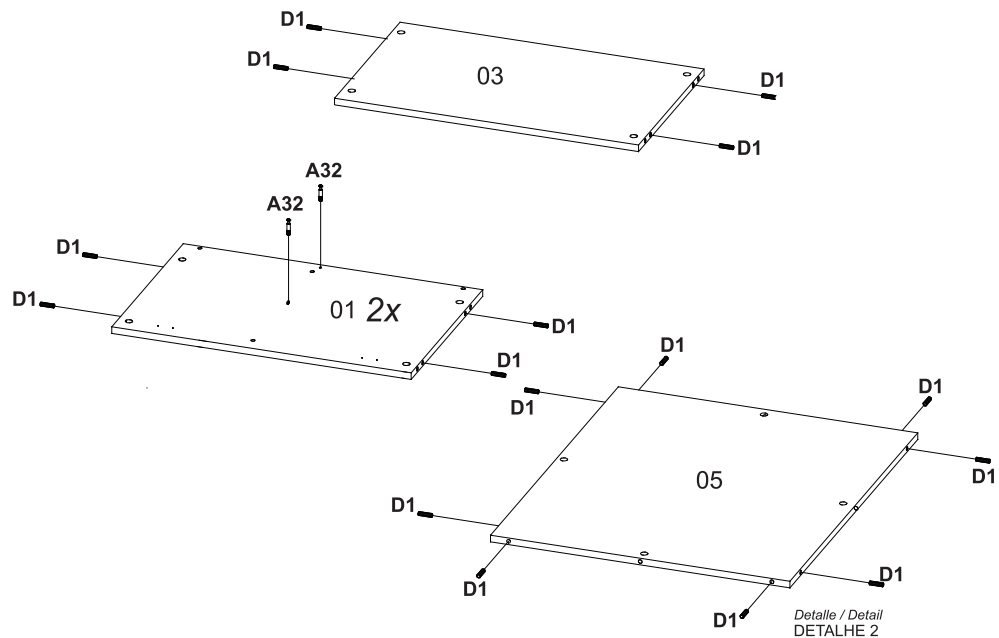

Monte a dobradiça e o calço.
 Após fixe na porta.
 Ensamble la bisagra y la cuña.
 Después de arreglar la puerta.
 Assemble the hinge and the shim.
 After fix on the door.

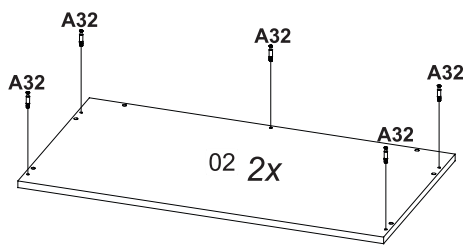

Detalle / Detail
 DETALHE 1



Pressione até o fundo do furo.
 Se necessário utilize um martelo de borracha.
 Presione hasta el fondo del agujero.
 Si es necesario, utilice un mazo de goma.
 Press to the bottom of the hole.
 If necessary use a rubber mallet.

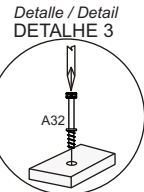

Parafuse com uma chave de fenda cruzada.
 Atornille con un destornillador cruzado.
 Screw with a crossed screwdriver.

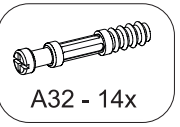
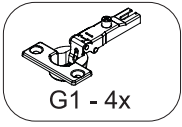
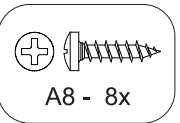
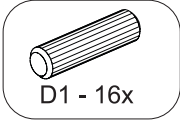

1

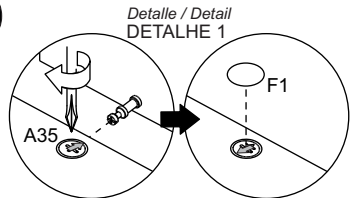

Depois de encaixar as peças coloque o tambor com a sua seta voltada para o parafuso. Para apertar Gire no sentido horário.
 Después de colocar las piezas, coloque el tambor con su flecha hacia el tornillo. Para apretar, gire en sentido horario.
 After fitting the parts, place the drum with its arrow facing the screw.
 To tighten, turn clockwise.

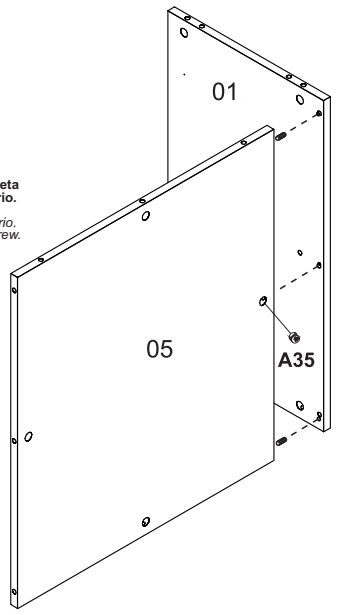
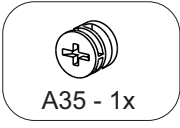
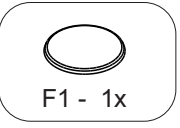

2

